

AMENDING  
SUBDIVISION PLAT ESTABLISHING  
THE ESTATES AT  
TRIPLE R RANCH  
UNIT 2  
WILSON COUNTY, TEXAS

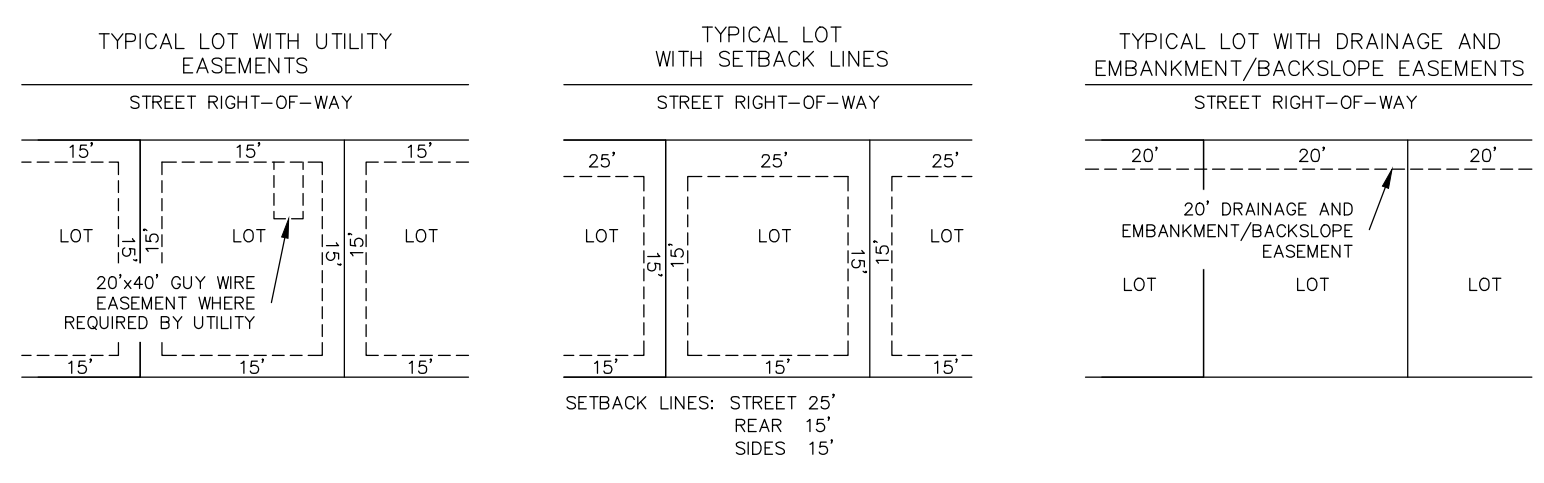

**INTREPID**  
SURVEYING & ENGINEERING  
P.O. Box 519 • 1004 C STREET  
FLORESVILLE, TX 78114  
D. 830.393.8833 • F. 830.393.3388  
WWW.INTREPIDTX.COM  
TBPLS #10193936 • TBPE #16550

LEGEND:		KEY NOTES:	
	BOUNDARY LINE		EXISTING VARIABLE WIDTH DRAINAGE AND UTILITY EASEMENT (12/97) W.C.P.R.
	ADJOINER LINE		30' DRAINAGE EASEMENT (12/97) W.C.P.R.
	EASEMENT LINE-EXISTING		20' DRAINAGE EASEMENT (C/250) W.C.P.R.
	EASEMENT LINE-PROPOSED		35' DRAINAGE EASEMENT (C/250) W.C.P.R.
	SURVEY LINE		(BRG.-DIST.) RECORD CALL
	OVERHEAD ELECTRIC EXISTING		FIRE HYDRANTS
	1/2" IRON ROD FOUND		
	1/2" IRON ROD SET		
	WILSON COUNTY PLAT RECORDS		
	WILSON COUNTY OFFICIAL PUBLIC RECORDS		
	WILSON COUNTY DEED RECORDS		

# TRIPLE R RANCH UNIT 2 EXHIBIT

